

Cesare 13kw Pellet Inset Stove

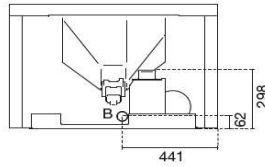

OPTIONAL

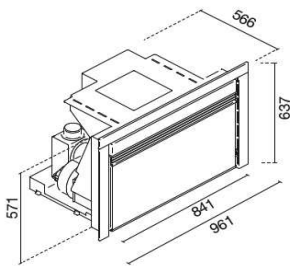
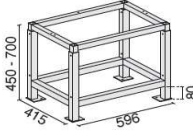

OPTIONAL

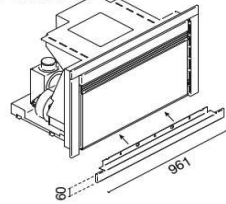

A = Ø 80 mm Scarico fumi / Flue / Cheminée / Rauchabzug / Evacuación de humos / Descarga de humos
 B = Ø 50 mm Aria combustione / Combustion air / Air de combustion / Verbrennungsluft / Aire para la combustión / Ar de combustão

Technical Data

Total Input Power: max 13,0 kW - min 5,7 kW
 Nominal heat output: max 11,5 kW - min 5,3 kW
 Energy efficiency class: A+
 Efficiency: Up to 93.5%
 CO emission at 13% O₂: 0.012%
 Pellet consumption: max 2,7 kg/h – min 1,2 kg/h
 Pellet bin capacity: 18 kg
 Heatable room volume: 200 – 300 mc
 Minimum distances: back/side: 100mm, front 100mm
 Minimum insert fixing hole size: W885 x H590mm
 Weight: 160 kg
 Complies with: EN14785 - B1mSchV II - LRV/VKF
 Support: Optional

Features

Front glass door with black etching
 Forced ventilation
 Front drawer for pellet loading
 18 kg Pellet tank
 5 operating power levels
 Cast iron brazier
 Removable handle
 Remote control supplied
 Safety thermostat
 Suitable for external thermostat
 Safety Manostat
 Lower frame: Optional
 Remote control: Optional
 WIFI module for remote control: Optional

Hamco

STOVES

Hamco Heating Ltd
 Cloncollig
 Church Road
 Tullamore
 Co. Offaly
 05793 21302
info@hamco.ie
www.hamco.ie